



XM 20 JC

Depureco Industrial Vacuums USA

19121 Marketplace Avenue, Building 1, Suite 165
Plum Creek Business Park • Kyle • TX 78640

www.depurecousa.com
info@depurecousa.com



2 POWERFUL BY-PASS MOTORS

120V
Max Airflow= 230 CFM
Max Depression= 94 inH2O

2,7 HP



POWER

5,500 in²



FILTER

6 gal Bin



CAPACITY

**(OPTIONAL)
FILTER CARTRIDGE
HEPA H14**



**JET-CLEAN
CLEANING SYSTEM**

Clean the filter with a powerful jet of air without stopping the unit.

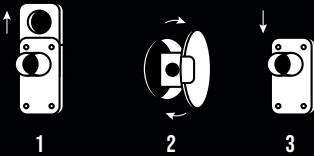

**CONICAL
CARTRIDGE**
5,500 in²



6 gal

**DETACHABLE BIN
ON WHEELS**

**INLET WITH
DEFLECTOR**

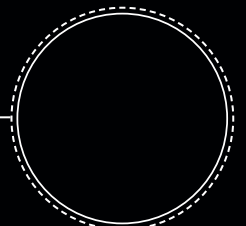

SPEC SHEET

	Units	XM 20
Motors Type		2 - By-Pass
Power	HP	2.7
Voltage Frequency	V Hz	120/60
Maximum vacuum	inH2O	94
Maximum air flow	CFM	230
Inlet	Ø in	2
Noise level - (EN ISO 3744)	dB(A)	72
Bin capacity	gal	6
Dimensions	in	20.3 X 21.5
Height	in	39.1
Weight	lb	84
Primary filter		
Type		Conical cartridge
Surface area Diameter (Class EN 60335-2-69)	in ² in	5,500
Media		M Class
Filter cleaning		PTFE coated Polyester
		JetClean
Absolute filter		
Surface area (Class - EN 1822)	in ²	3,500
Media		H14
		Fiberglass

OPTIONAL FILTERS



HEPA filter Kit
Absolut filter with
heightening ring

OPTIONAL



AB
Accessory basket



GRD
Grounding



BX
AISI 304 stainless steel bin



GX
AISI 304 stainless steel bin
and chamber

ACCESSORIES



W&D Fixed brush
floor tool cleaning



Dry Kit
Ø 1,5 in

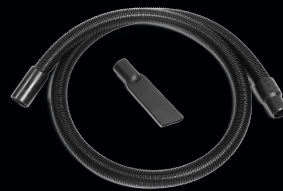

Starter Kit
Ø 1,5 in